

CERAMIC SCONCE - SMALL

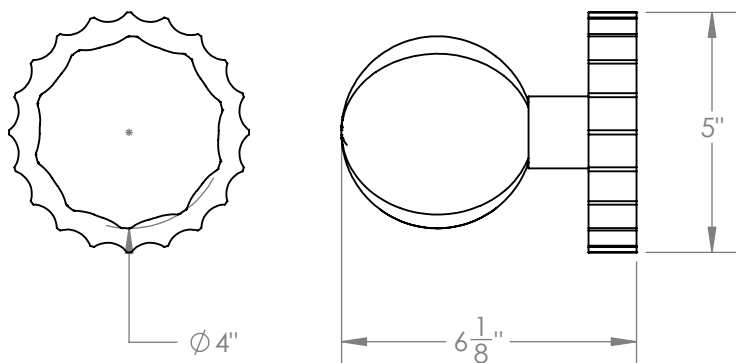

Composed of hand blown ridged glass with a glazed scalloped puck.
The textural differences are picked up beautifully by the light.



Materials

Ceramic
Glass
Steel
Brass

Standard Finishes

Antique Brass
Cream Glazed Ceramic
White Frosted Glass

Dimensions

5" W x 5" H x 6-1/8" D

Notes

Lamping: 1 G9 bulb, max 50W each. 4.5W dimmable LED bulb included.
450 lumens, 2700K color temperature.
120V, UL approved. (240V available)

Retail

\$2,000

Lead Time

8-10 Weeks

Customization Available - please contact us. **Weight** ~3 lbs